

Continental[®] BATTERIES

DATA SHEET

86-CS

PART # 86-CS
BCI 86
VOLTAGE 12V
Ah 48



PHYSICAL SPECIFICATIONS

Battery Type	Weight	Dimensions (L x W x H)	Container Material	Cover Material	Seperator Material	Handle Option
Flooded	32.94 lbs 14.9 kgs	8.98 x 6.77 x 7.76" 228.1 x 172 x 197.1 mm	Polypropylene	Polypropylene	Polyethylene	Yes

ELECTRICAL SPECIFICATIONS

Nominal Voltage	SAE CCA (-18°C/0°F)	SAE CA (0°C/32°F)	SAE RC (27°C/80°F)	Ref. Ah Capacity 20 Hr	Battery Terminal Type	Electrolyte Specific Gravity Range
12.6 V	600 A	750 A	90 Min	48 Ah	Top Post SAE Type A	1.270-1.300

MISC SPECIFICATIONS

Maximum Discharge Current	1000 A (5 sec)
Positive Grid Alloy	Lead Calcium Tin
Negative Grid Alloy	Lead Calcium
Terminal Polarity	+ -

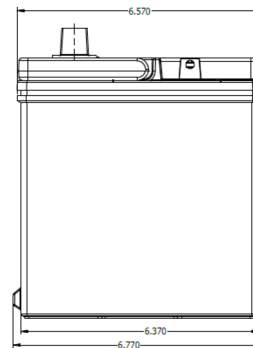
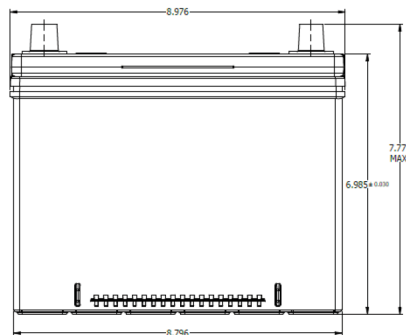
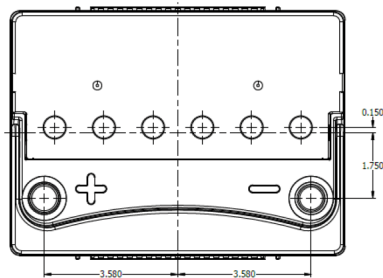

WWW.GOCBS.COM

